

DATE: 17 May 2024
DESIGNER:
PROJECT No: 2972
PROJECT NAME: Social Housing Bundle

**LIGHTING
REALITY**

Development at Coolaghknock

Layout Report

General Data

Dimensions in Metres Angles in Degrees

Calculation Grids

ID	Grid Name	X	Y	X' Length	Y' Length	X' Spacing	Y' Spacing
1	Coolaghknock Development	140.02	-74.37	172.48	365.31	1.50	1.49
2	Main Infrastructure Route/...	112.28	76.56	88.48	98.41	1.50	1.49
3	Main Entrance	-7.21	186.29	18.95	71.22	1.46	1.48

Luminaires

Luminaire A Data



Supplier	Urbis Schreder
Type	AXIA 2.1 5167 Integrated lenses 16 OSOLON SQUARE GIANT@760mA
Lamp(s)	16 OSOLON SQUARE GIANT@760mA NW 74 0 230V 00-36-648
LampFlux(klm)/Colour	5.20 NW 4000K/70
File Name	AXIA 2.1 5167 16 OSOLON SQUARE GIANT 7 60mA NW 740 39W 434362 Integrated lens...
Maintenance Factor	0.84
Imax70,80,90(cd/klm)	1162.3, 202.9, 3.0
No. in Project	37

Luminaire B Data



Supplier	Urbis Schreder
Type	AXIA 2.1 5166 Integrated lenses 8 OSOLON SQUARE GIANT@600mA N
Lamp(s)	8 OSOLON SQUARE GIANT@600mA NW 740 230V 00-36-648
LampFlux(klm)/Colour	2.21 NW 4000K/70
File Name	AXIA 2.1 5166 8 OSOLON SQUARE GIANT 60 0mA NW 740 17W 464222 Integrated lenses...
Maintenance Factor	0.84
Imax70,80,90(cd/klm)	1083.7, 150.6, 1.2
No. in Project	11

Layout

ID	Type	X	Y	Height	Angle	Tilt	Cant	Out-reach	Target X	Target Y	Target Z
1	A	20.27	282.10	6.00	132.00	0.00	0.00	0.60			
2	A	0.27	263.36	6.00	132.00	0.00	0.00	0.60			
3	A	-17.91	246.54	6.00	132.00	0.00	0.00	0.60			
4	A	-19.13	223.67	6.00	229.00	0.00	0.00	0.60			
5	A	-3.57	206.94	6.00	229.00	0.00	0.00	0.60			
6	A	19.03	206.48	6.00	311.00	0.00	0.00	0.60			
7	A	37.29	223.37	6.00	311.00	0.00	0.00	0.60			
8	A	56.89	241.69	6.00	311.00	0.00	0.00	0.60			
9	A	63.59	164.99	6.00	311.00	0.00	0.00	0.60			
10	A	82.12	182.02	6.00	311.00	0.00	0.00	0.60			
11	A	102.49	200.98	6.00	311.00	0.00	0.00	0.60			
12	A	119.91	178.30	6.00	44.00	0.00	0.00	0.60			
13	A	133.05	162.40	6.00	47.00	0.00	0.00	0.60			
14	A	148.50	147.85	6.00	39.00	0.00	0.00	0.60			
15	A	169.00	128.87	6.00	131.00	0.00	0.00	0.60			
16	A	130.25	92.92	6.00	131.00	0.00	0.00	0.60			
17	A	148.31	109.90	6.00	131.00	0.00	0.00	0.60			
18	A	90.74	123.18	6.00	223.00	0.00	0.00	0.60			

Layout Continued

ID	Type	X	Y	Height	Angle	Tilt	Cant	Out-reach	Target X	Target Y	Target Z
19	A	33.24	185.93	6.00	223.00	0.00	0.00	0.60			
20	A	49.38	168.41	6.00	223.00	0.00	0.00	0.60			
21	A	76.54	139.26	6.00	223.00	0.00	0.00	0.60			
22	A	105.64	107.52	6.00	223.00	0.00	0.00	0.60			
23	A	132.76	78.28	6.00	223.00	0.00	0.00	0.60			
24	A	148.22	56.26	6.00	209.00	0.00	0.00	0.60			
25	A	167.01	37.80	6.00	134.00	0.00	0.00	0.60			
26	A	213.87	81.43	6.00	132.00	0.00	0.00	0.60			
27	A	184.26	53.98	6.00	132.00	0.00	0.00	0.60			
28	A	198.67	0.03	6.00	321.00	0.00	0.00	0.60			
29	A	247.69	43.60	6.00	321.00	0.00	0.00	0.60			
30	A	220.41	18.32	6.00	321.00	0.00	0.00	0.60			
31	A	168.74	19.45	6.00	224.00	0.00	0.00	0.60			
32	A	184.06	2.78	6.00	219.00	0.00	0.00	0.60			
33	A	-18.37	193.01	6.00	314.00	0.00	0.00	0.60			
34	A	-28.95	178.57	6.00	329.00	0.00	0.00	0.60			
35	A	-52.20	206.82	6.00	133.00	0.00	0.00	0.60			
36	B	-41.48	214.13	6.00	41.00	0.00	0.00	0.60			
37	B	-47.96	183.24	6.00	232.00	0.00	0.00	0.60			
39	B	-6.42	170.95	6.00	174.00	0.00	0.00	0.60			
40	B	5.32	174.01	6.00	321.00	0.00	0.00	0.60			
41	B	25.41	154.80	6.00	133.00	0.00	0.00	0.60			
44	B	49.39	141.06	6.00	42.00	0.00	0.00	0.60			
45	B	64.74	119.21	6.00	45.00	0.00	0.00	0.60			
53	B	131.39	49.51	6.00	27.00	0.00	0.00	0.60			
54	B	82.18	99.66	6.00	51.00	0.00	0.00	0.60			
55	B	66.53	107.24	6.00	321.00	0.00	0.00	0.60			
58	B	101.30	84.21	6.00	55.00	0.00	0.00	0.60			
59	A	197.72	66.71	6.00	127.00	0.00	0.00	0.60			
60	A	-38.74	246.89	6.00	223.00	0.00	0.00	0.60			

Horizontal Illuminance (lux)

Coolaghknock Development

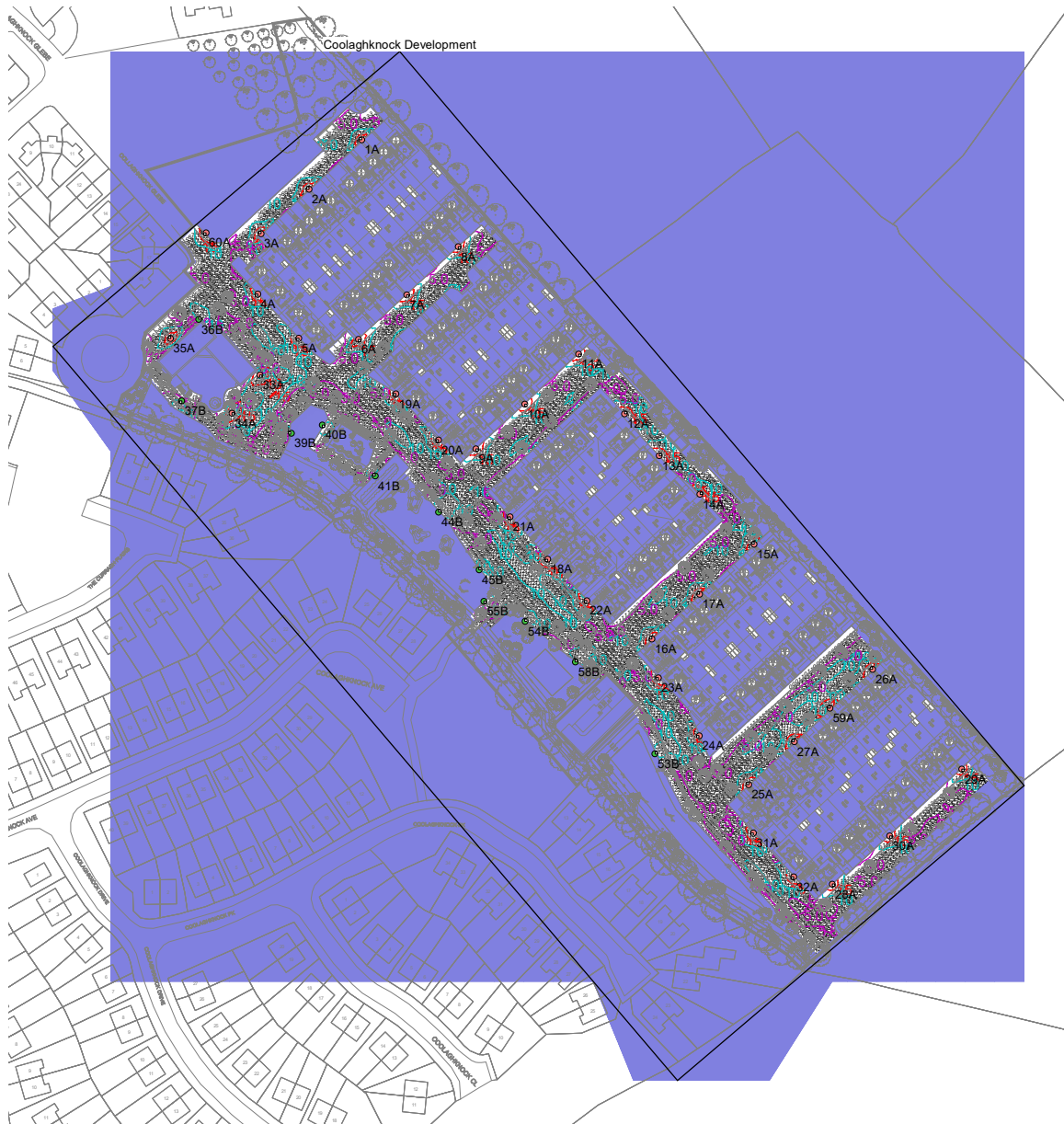

Results

Eav	7.98
Emin	0.30
Emax	19.35
Emin/Emax	0.02
Emin/Eav	0.04

Horizontal Illuminance (lux)

Main Infrastructure Route/Block

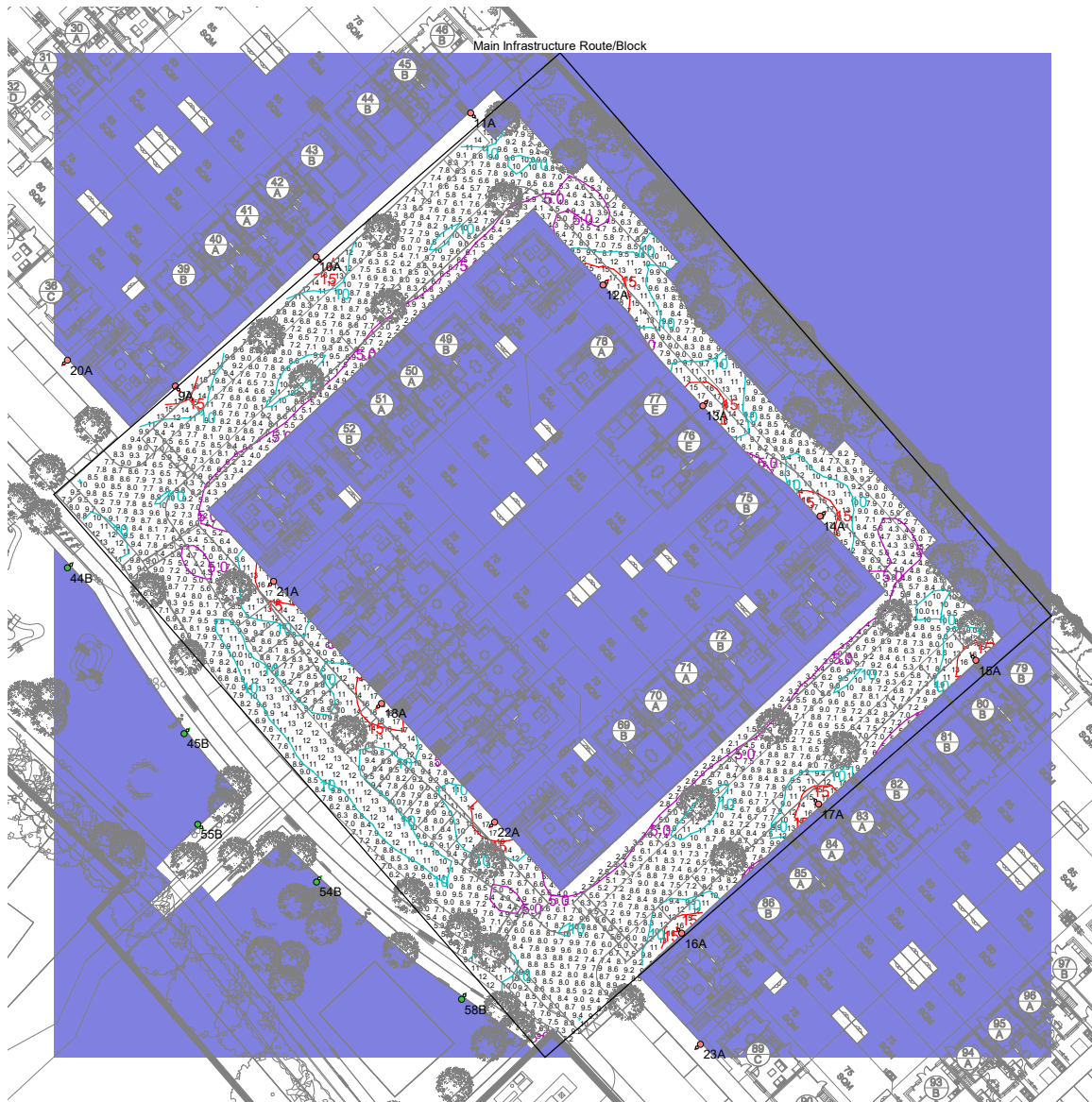

Results

Eav	8.59
Emin	1.50
Emax	17.81
Emin/Emax	0.08
Emin/Eav	0.17

Horizontal Illuminance (lux)

Main Entrance

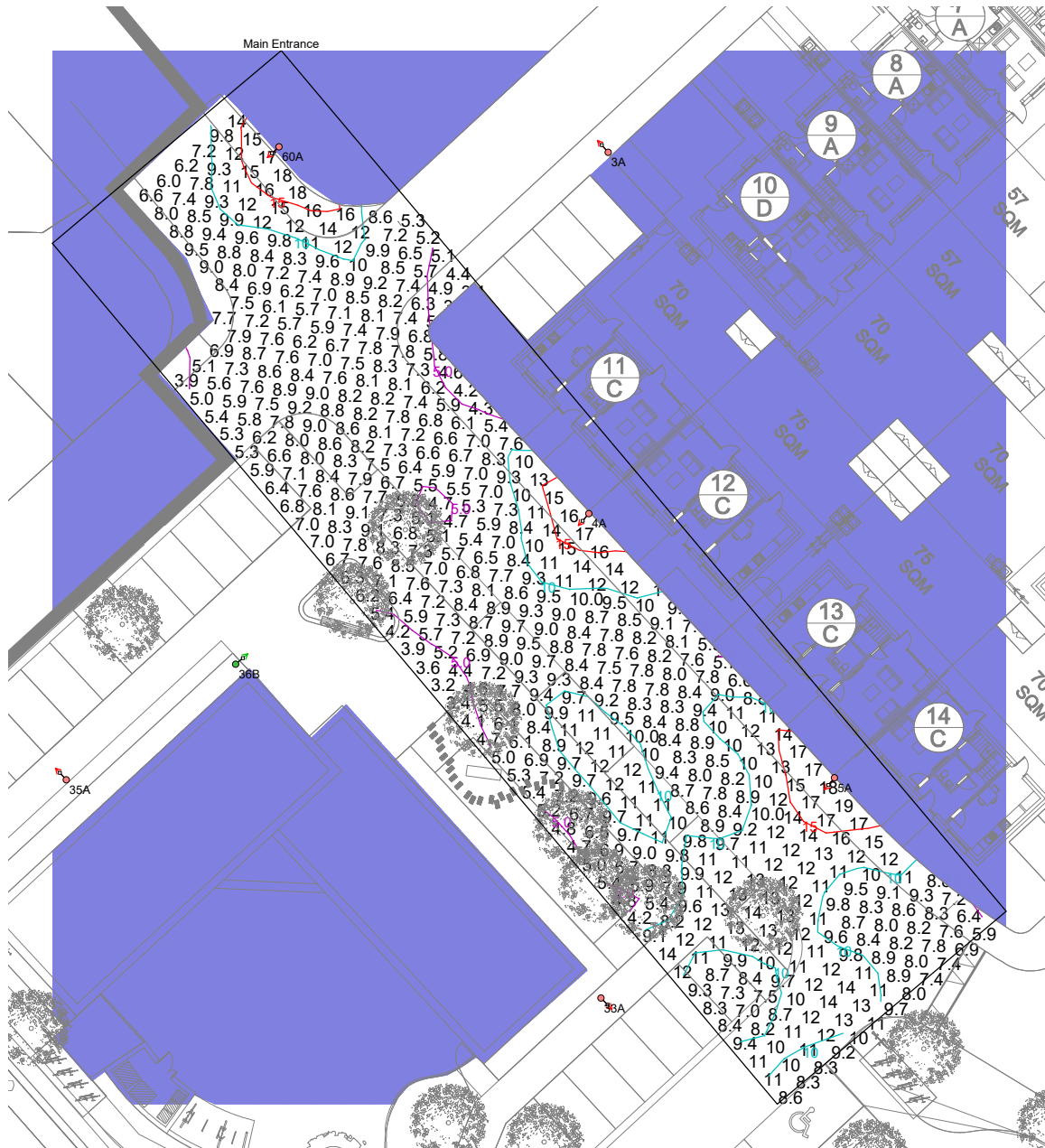

Results

Eav	8.91
Emin	3.08
Emax	18.80
Emin/Emax	0.16
Emin/Eav	0.35